

985357

SEAT BELT INSTRUCTION SHEET

FRONT SEAT CHEVROLET, CHEVY, CORVAIR, & CORVAIR 95, (GREENBRIER)

NOTE: FOR OPERATING INSTRUCTIONS FOR OWNER, PLACE LAST SHEET IN GLOVE COMPARTMENT

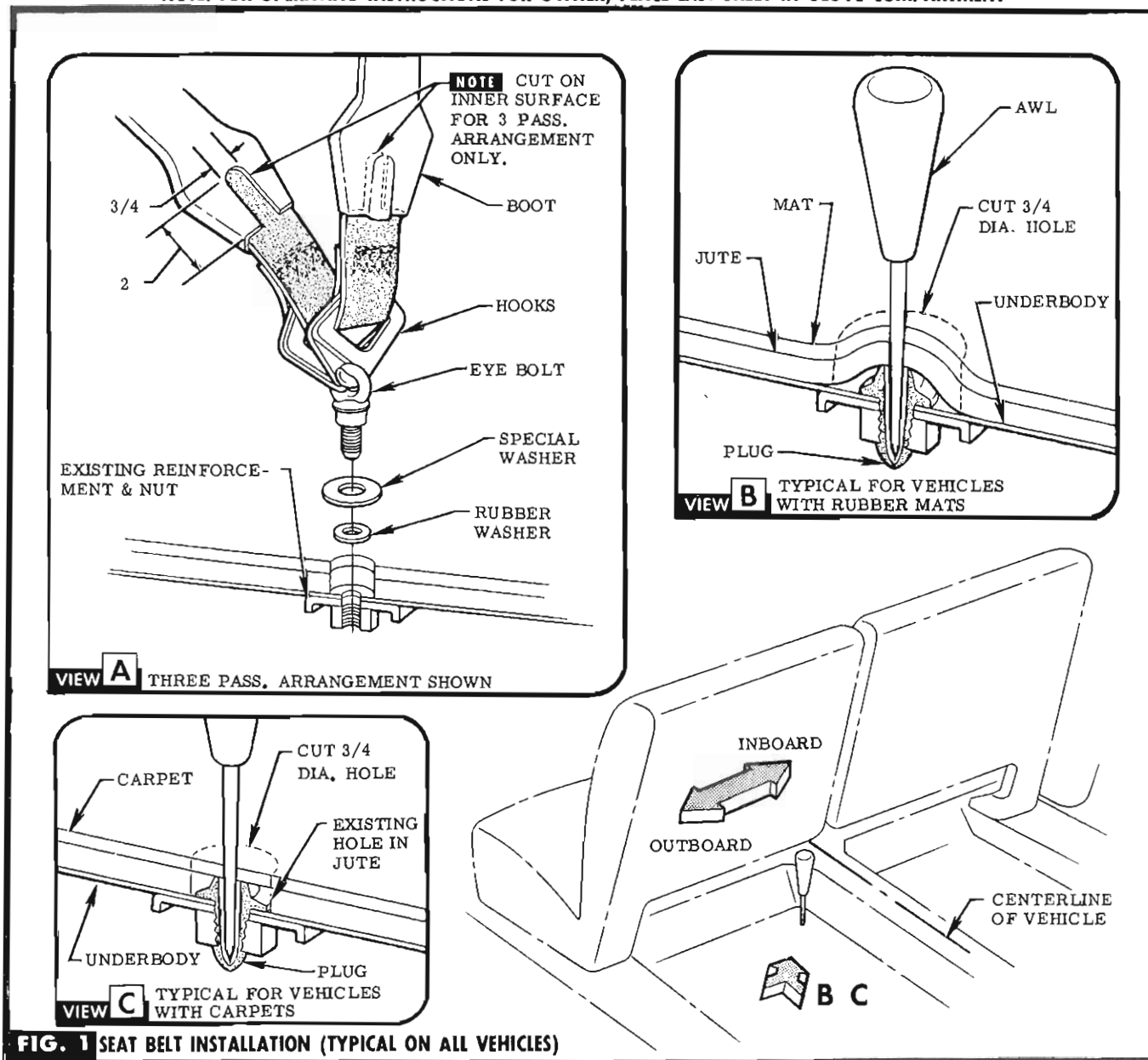

STEP 1 USING DIMENSIONS GIVEN, LOCATE PLUG BY FEELING CARPET (SLIGHT INDENTATION) OR UNDER RUBBER MAT (SLIGHT HUMP). PROBE WITH AWL TO LOCATE HOLE IN PLUG. INSERT AWL DOWN INTO PLUG & LEAVE STANDING IN UPRIGHT POSITION, CUT CARPET OR MAT. SEE FIG. 1 (VIEW B & C) &

FIG. 2 - CHEVROLET
FIG. 3 - CHEVY
FIG. 4 - CORVAIR
FIG. 5 - CORVAIR 95 (GREENBRIER)

STEP 2 REMOVE PLUGS & INSTALL EYE-BOLTS. POSITION

INBOARD EYE-BOLTS PARALLEL WITH CENTERLINE OF VEHICLE & OUTBOARD EYE-BOLTS PERPENDICULAR WITH CENTERLINE OF VEHICLE. SEE FIG. 1 & VIEW A.

NOTE Install special washer on eye-bolt then force rubber washer over threaded portion & seat tight against shoulder of eye-bolt. Special washer used only on vehicles with carpets. See Fig. 1 (View A).

STEP 3 WHEN INSTALLING TWO BELTS ON ONE EYE-BOLT, BOOTS MUST BE CUT. SEE FIG. 1 (VIEW A).

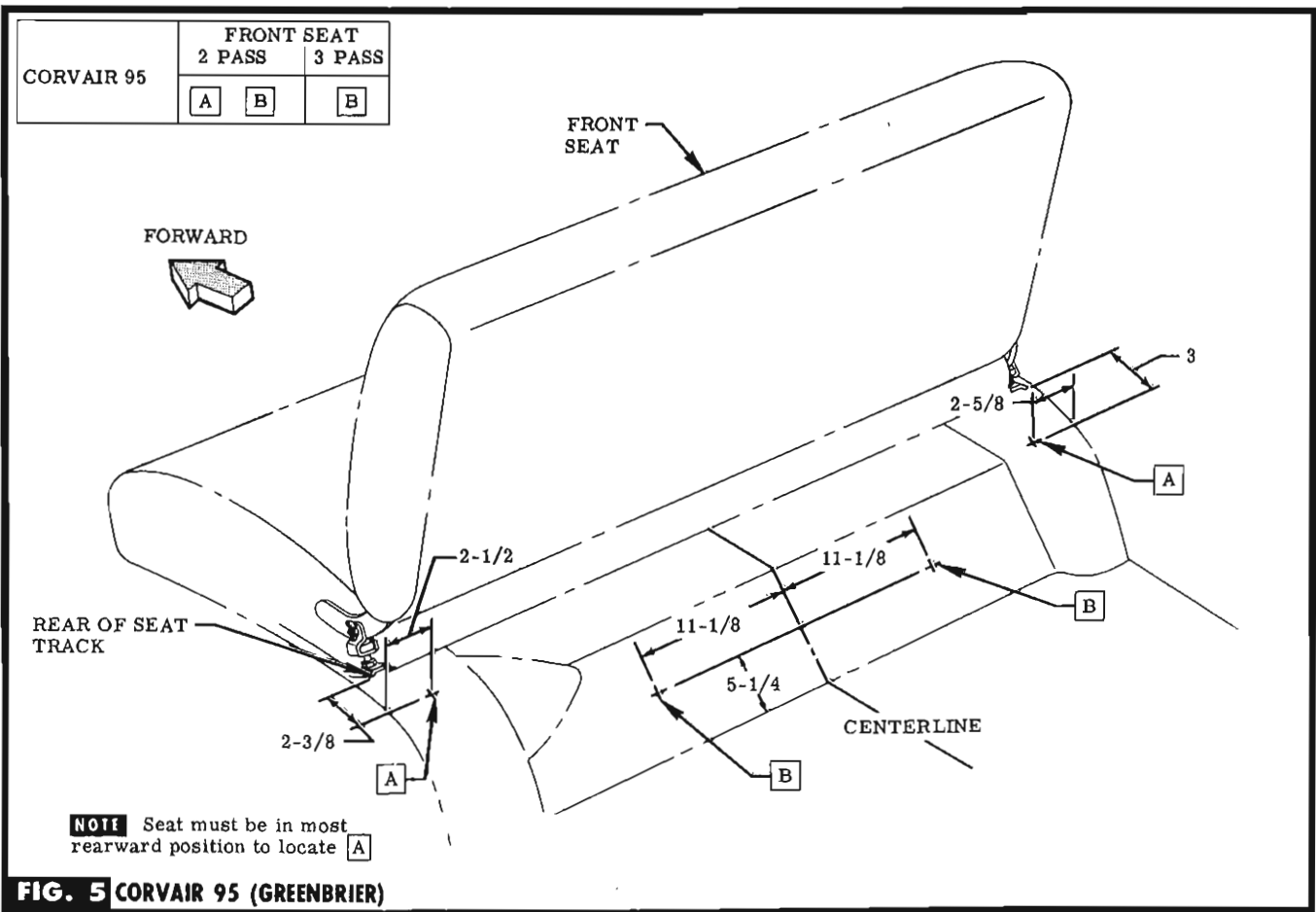
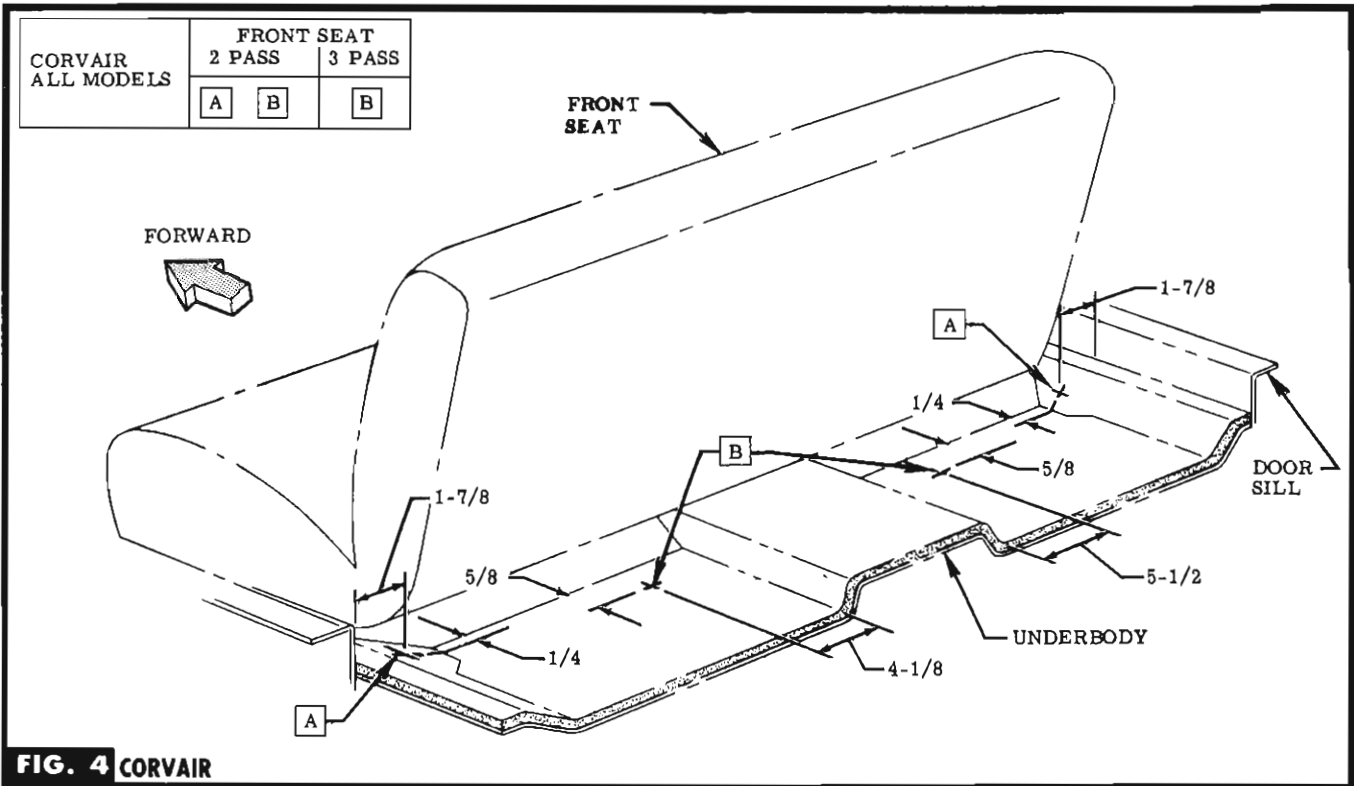

DEALER: PLACE THIS SHEET IN GLOVE COMPARTMENT

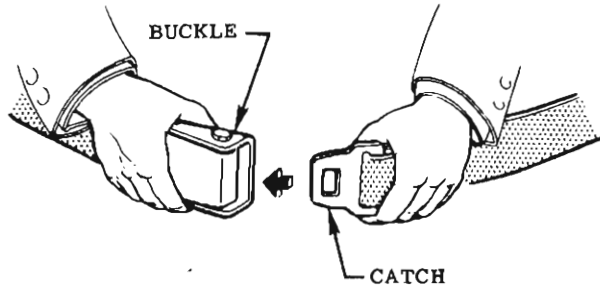

INSERT CATCH TO LATCH BUCKLE

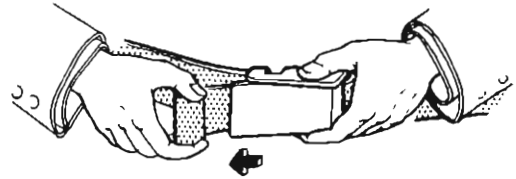

PULL TO TIGHTEN BELT

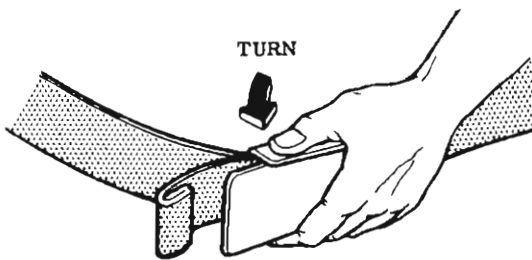

TO LOOSEN BELT TURN BUCKLE OUTWARD

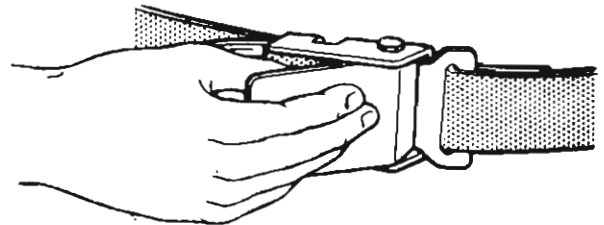

TO UNLATCH PULL LEVER OUTWARD

NOTE Adjust belt length to suit individual requirement. With belt correctly adjusted, person should not feel the weight of the Buckle asm. on the abdomen. At no time should the belt allow more than 1 inch forward movement of the body.

NOTE When not in use belts should be carefully layed on seat & kept off the floor.

CLEAN BELTS WITH CLEANER OR DETERGENT RECOMMENDED FOR NYLON.

CAUTION Do not bleach or redye belts as this may cause severe loss of strength.

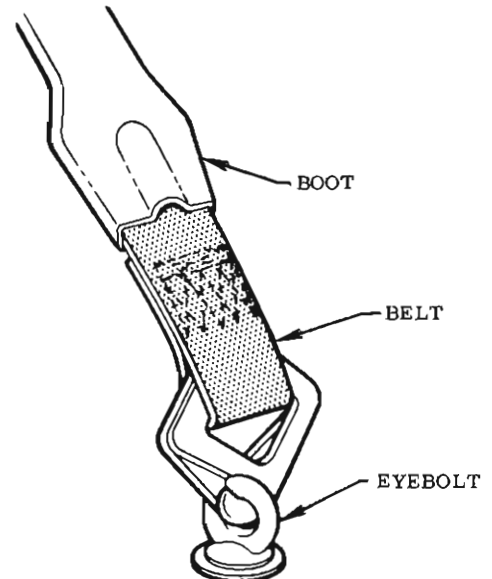

BELT ATTACHMENT TO EYEBOLT (WITH BOOT IN RAISED POSITION)

FIG. 8 OPERATION PROCEDURE & BELT ADJUSTMENT

985180 *CHEVY II
SEAT BELT INSTRUCTION SHEET

CHEVROLET, CORVAIR, CORVAIR 95, * _____, & TRUCK

NOTE: FOR OPERATING INSTRUCTIONS FOR OWNER, PLACE LAST SHEET IN GLOVE COMPARTMENT



GENERAL MOTORS PARTS DIVISION
GENERAL MOTORS CORPORATION
DETROIT 2, MICHIGAN

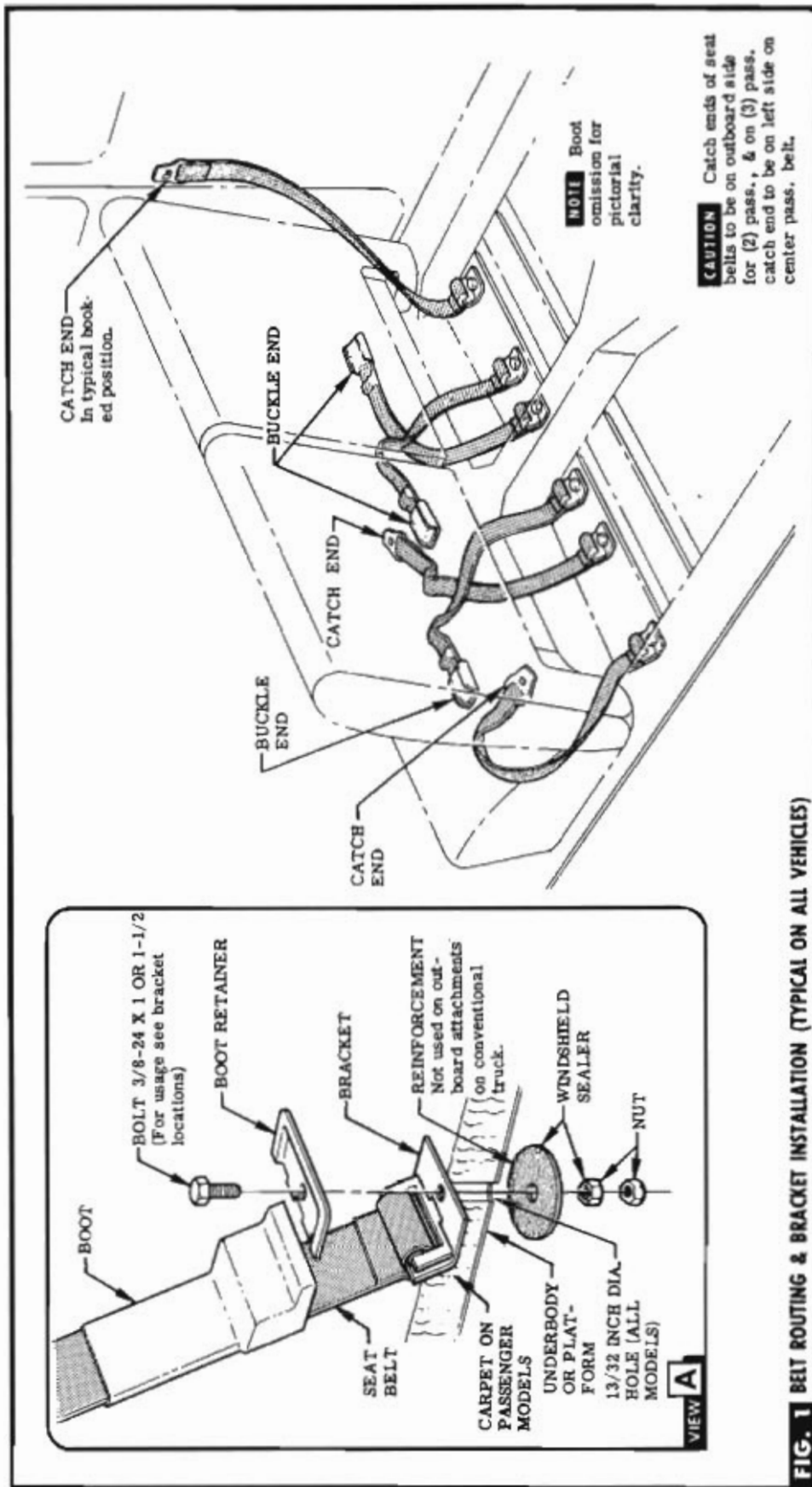

FIG. 1 BELT ROUTING & BRACKET INSTALLATION (TYPICAL ON ALL VEHICLES)

STEP 1 REMOVE SEAT CUSHIONS & BACKS OR FOLD SEATS FORWARD FOR ACCESSIBILITY, ALSO TURN BACK FLOOR MAT AT AREA OF INSTALLATION. PIERCE & SLIT AREA OF MAT AT BRACKET LOCATIONS.

STEP 2 LOCATE, CENTERPUNCH & DRILL HOLES THRU UNDERBODY OR PLATFORMS. SEE VIEW A &

FIG. 2 - CHEVROLET

FIG. 3 - CORVAIR

FIG. 4 - CORVAIR 95

FIG. 5 - PANEL TRUCKS

FIG. 6 - SUBURBAN TRUCKS

FIG. 7 - CONVENTIONAL TRUCK

FIG. 8 - TILT CABS

FIG. 9 - (EXCEPT STATION WAGON)

FIG. 10 - (EXCEPT STATION WAGON)

FIG. 11 - (EXCEPT STATION WAGON)

FIG. 12 - (EXCEPT STATION WAGON)

FIG. 13 - (EXCEPT STATION WAGON)

attach Boot Retainer when installing Bracket.

STEP 4 ON 4-DOOR CHEVROLET, 2 & 4-DOOR CORVAIRS, & *_____, FRONT SEAT BACK MUST BE SLIT PRIOR TO ATTACHING SEAT BELTS TO BRACKETS. SEE FIG. 12 & 13.

STEP 5 ATTACH SEAT BELTS TO BRACKET & ADJUST TO PROPER LENGTH. SEE VIEW A & FIG. 15. **NOTE** If boots are to be installed, thread belt thru boot prior to attaching. Also if seat has been slit, thread thru seat prior to installing boot, or attaching to bracket.

STEP 6 REPLACE SEATS.

STEP 7 INSTALL COAT HOOKS & SCREWS FURNISHED FOR OUTBOARD BELT STOWAGE. SEE FIG. 11 VIEW R, FIG. 12 VIEW S & T.

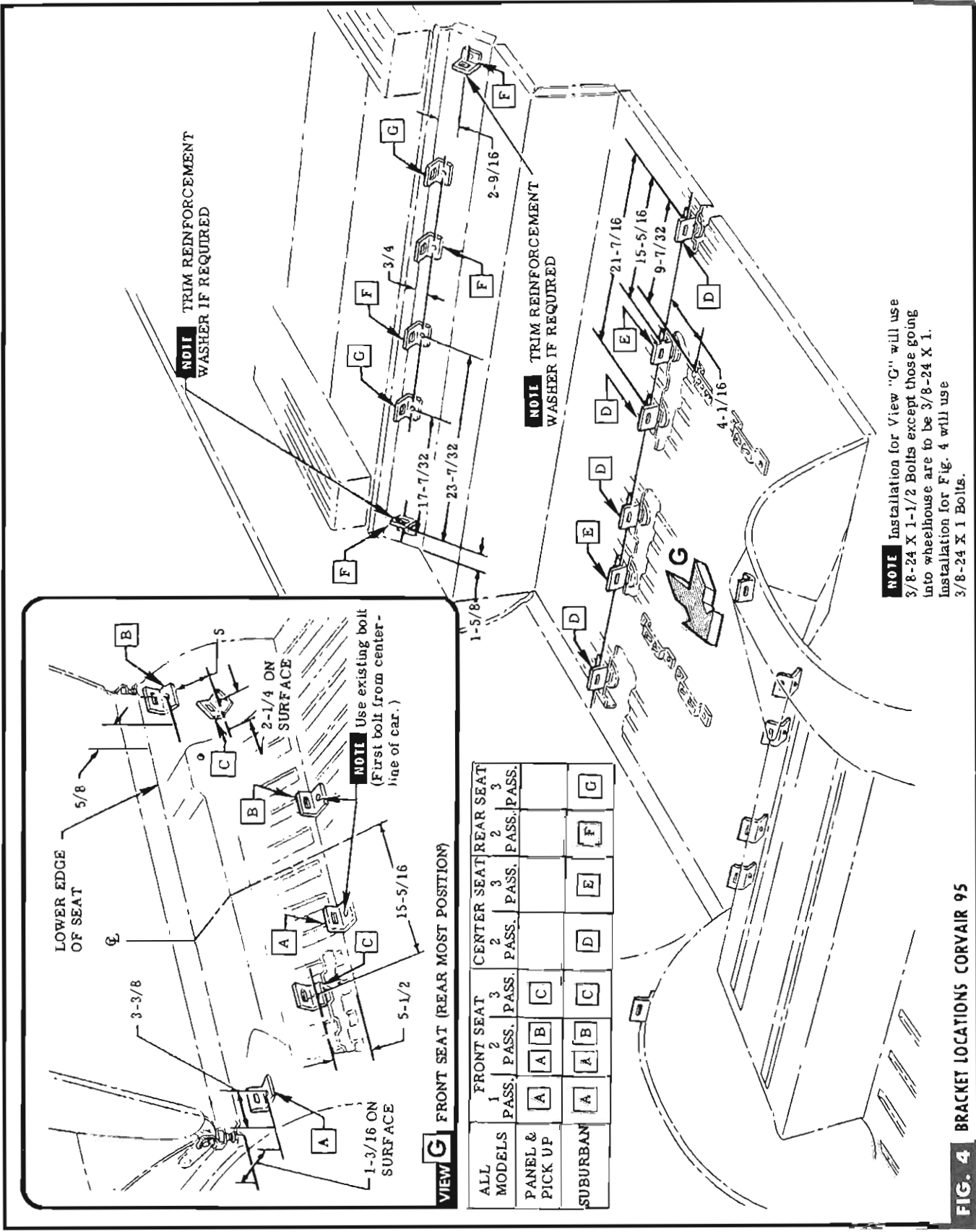

LOWER EDGE OF SEAT

3-3/8

5/8

2-1/4 ON SURFACE

15-5/16

1-3/16 ON SURFACE

5-1/2

NOTE: Use existing bolt (First bolt from center-line of car.)

NOTE: TRIM REINFORCEMENT WASHER IF REQUIRED

3/4

1-5/8

17-7/32

23-7/32

2-9/16

NOTE: TRIM REINFORCEMENT WASHER IF REQUIRED

21-7/16

15-5/16

9-7/32

4-1/16

VIEW G FRONT SEAT (REAR MOST POSITION)

ALL MODELS	FRONT SEAT			CENTER SEAT			REAR SEAT		
	1 PASS.	2 PASS.	3 PASS.	1 PASS.	2 PASS.	3 PASS.	1 PASS.	2 PASS.	3 PASS.
PANEL & PICK UP	A	A	B	C					
SUBURBAN	A	A	B	C	D	E	F	G	

NOTE: Installation for View "G" will use 3/8-24 X 1-1/2 Bolts except those going into wheelhouse are to be 3/8-24 X 1. Installation for Fig. 4 will use 3/8-24 X 1 Bolts.

FIG. 4 BRACKET LOCATIONS CORVAER 95

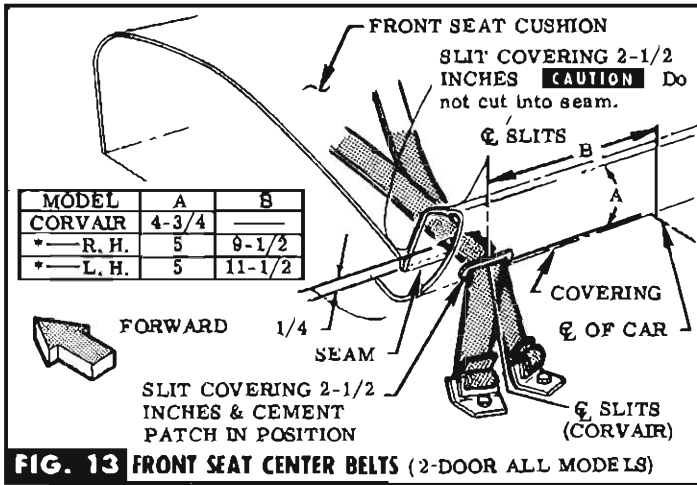

FIG. 13 FRONT SEAT CENTER BELTS (2-DOOR ALL MODELS)

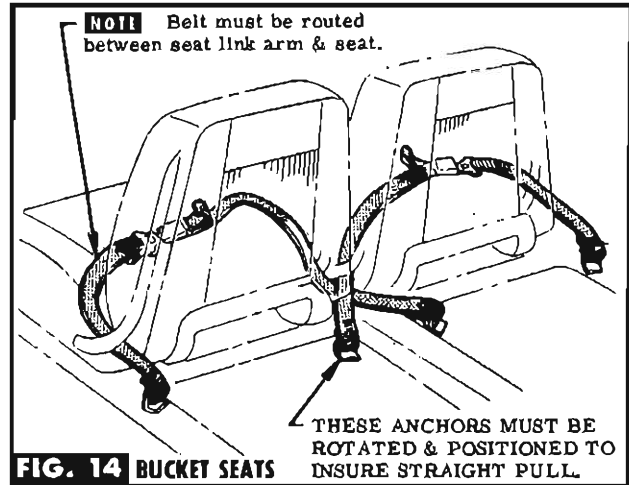

FIG. 14 BUCKET SEATS

CUT ON THIS LINE

DEALER: PLACE THIS PORTION OF SHEET IN GLOVE COMPARTMENT

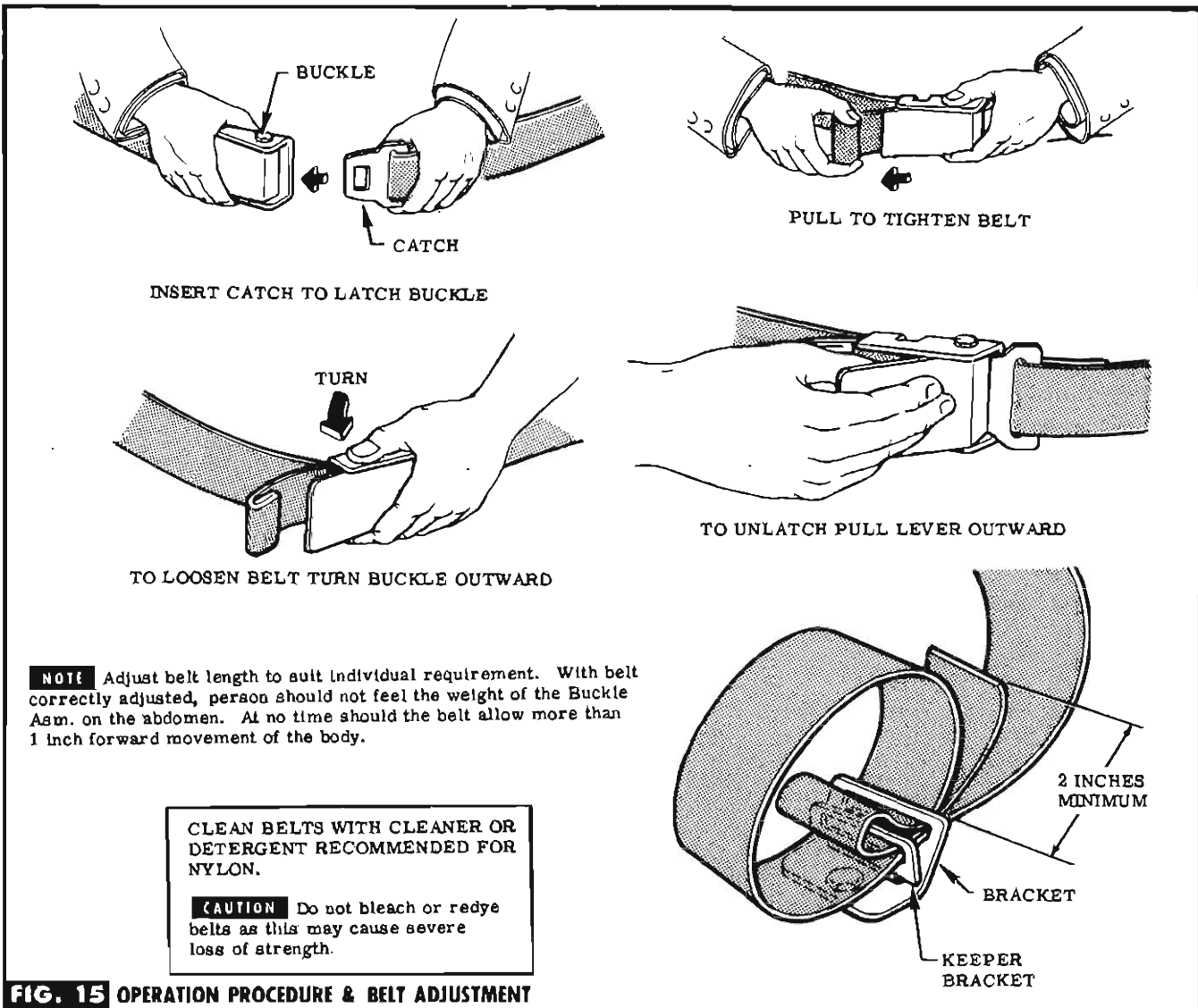

FIG. 15 OPERATION PROCEDURE & BELT ADJUSTMENT