

985104
CARGO NETTING INSTRUCTION SHEET
 GREENBRIER 1206

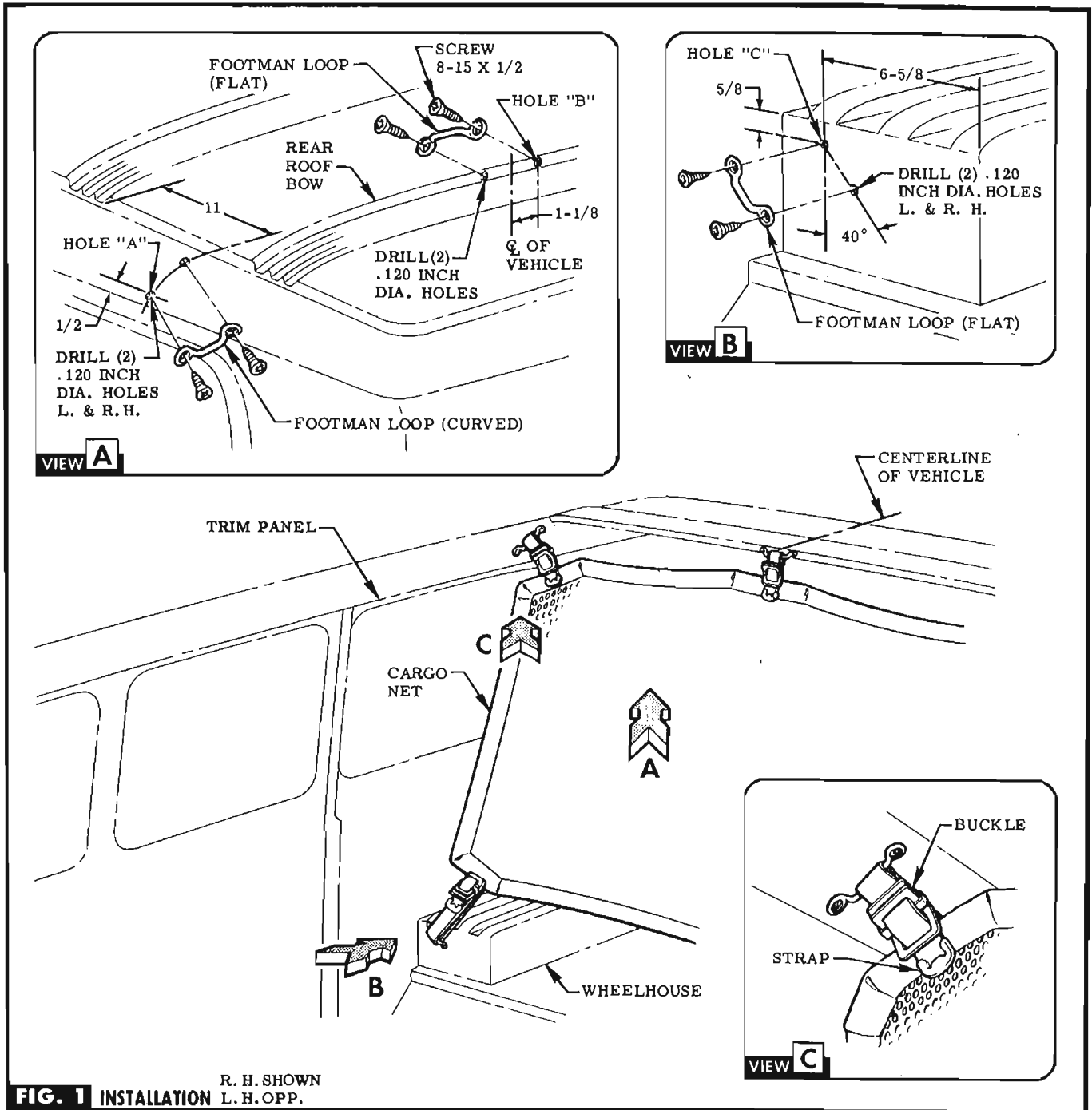

FIG. 1 INSTALLATION

STEP 1 USING DIMENSIONS SHOWN LOCATE, CENTER PUNCH & DRILL HOLES "A", "B" & "C". FASTEN FOOTMAN LOOPS WITH SCREWS LOOSELY INSTALLED. SEE FIG. 1 & VIEWS A & B.

STEP 2 USE FOOTMAN LOOP AS TEMPLATE & DIMENSIONS SHOWN, DRILL THRU REMAINING HOLES. INSTALL REMAINING SCREWS & TIGHTEN ALL SCREWS. SEE FIG. 1 &

VIEWS A & B.

STEP 3 INSTALL NET MAKING SURE BUCKLES FACE TOWARD FRONT OF VEHICLE. LOOP STRAP THRU FOOTMAN LOOP THEN THRU BUCKLE. SEE FIG. 1 & VIEW C.

CAUTION Do not tighten until all (5) buckles are fastened. Apply tension to net by taking in straps. See Fig. 1 & View C.